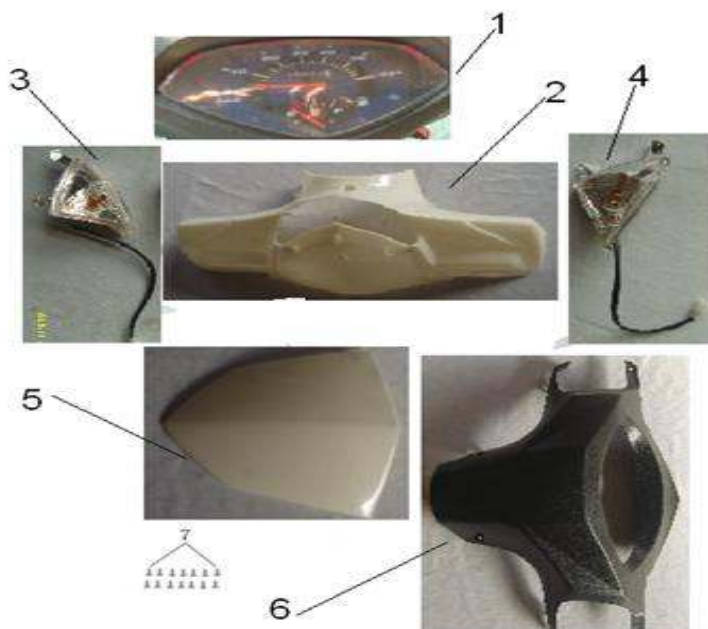

FIG. 01 METER & FRONT COVER / KILOMETAR SAT I PLASTIKE VOLANA



NO.	PART NO.	DESCRIPTION IN SERBIAN	DESCRIPTION IN ENGLISH
1	HL50QT-21(10)-01-001	KM Sat	METER
2	HL50QT-21(10)-01-002	Gornja plastika volana	UPPER BOW CAP
3	HL50QT-21(10)-01-003	Desni žmigavac	R.FLASHER LIGHT 12 V/10W
4	HL50QT-21(10)-01-004	Levi žmigavac	L.FLASHER LIGHT 12 V/10W
5	HL50QT-21(10)-01-005	Haber	DECORATION,BOW CAP
6	HL50QT-21(10)-01-006	Donja plastika volana	LOWER BOW CAP
7	HL50QT-21(10)-01-007	Vijak M5×20	BOLT M5×20

FIG. 02 STEERING HANDLE / VOLAN



NO.	PART NO.	DESCRIPTION IN SERBIAN	DESCRIPTION IN ENGLISH
1	HL50QT-21(10)-02-001	Volan	STEERING HANDLE
2	HL50QT-21(10)-02-002	Desni grip	R.GRIP HANDLE
3	HL50QT-21(10)-02-003	Levi Grip	L.GRIP HANDLE
4	HL50QT-21(10)-02-004	Desni prekidač	HEADLIGHT SWITCH
5	HL50QT-21(10)-02-005	Levi prekidač	TURNING SWITCH □ HORN BUTTON,
6	HL50QT-21(10)-02-006	Vijak M5×20	BOLT M5×20
7	HL50QT-21(10)-02-007	Vijak M5×30	BOLT M5×30
8	HL50QT-21(10)-02-008	Vijak M10×45	BOLT M10×45
9	HL50QT-21(10)-02-009	Platna M10	NUT M10

FIG. 03 FRONT COVER & HEADLIGHT / PREDNJA MASKA I FAR

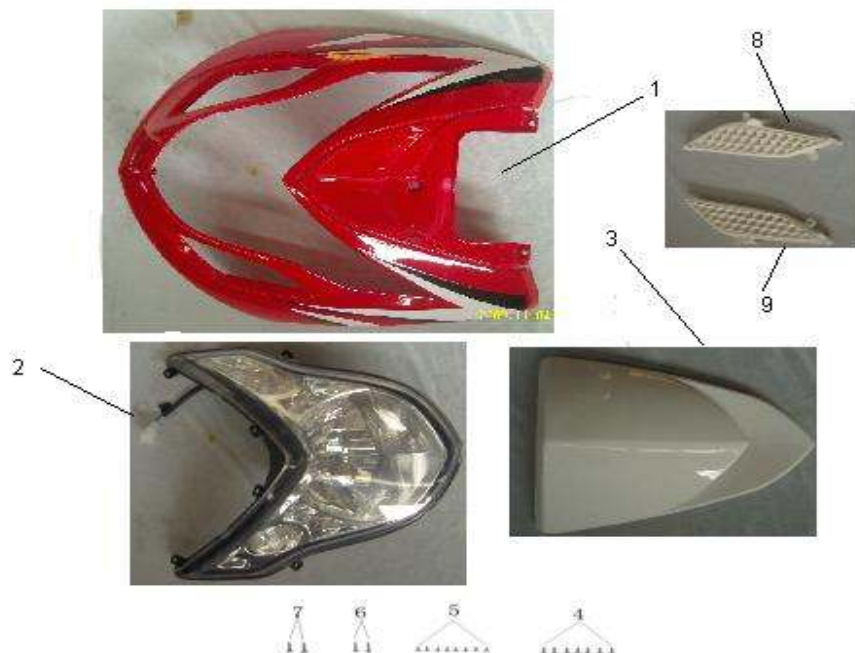

NO.	PART NO.	DESCRIPTION IN SERBIAN	DESCRIPTION IN ENGLISH
1	HL50QT-21(10)-03-001	Prednja maska	FRONT COVER
2	HL50QT-21(10)-03-002	Far	HEADLIGHT 12V/35W/35W
3	HL50QT-21(10)-03-003	Haber	DECORATION BOARD
4	HL50QT-21(10)-03-004	vijak ST4.8×12	SCREW ST 4.8×12
5	HL50QT-21(10)-03-005	vijak ST4.2×12	SCREW ST 4.2×12
6	HL50QT-21(10)-03-006	vijak ST4.2×16	SCREW ST 4.2×16
7	HL50QT-21(10)-03-007	vijak ST4.8×16	SCREW ST 4.8×16
8	HL50QT-21(10)-03-004	Ukrasni poklopac desni	SIDE COVER.R
9	HL50QT-21(10)-03-005	Ukrasni poklopac levi	SIDE COVER.L

FIG. 04 FRONT FENDER / PREDNJI BLATOBAN

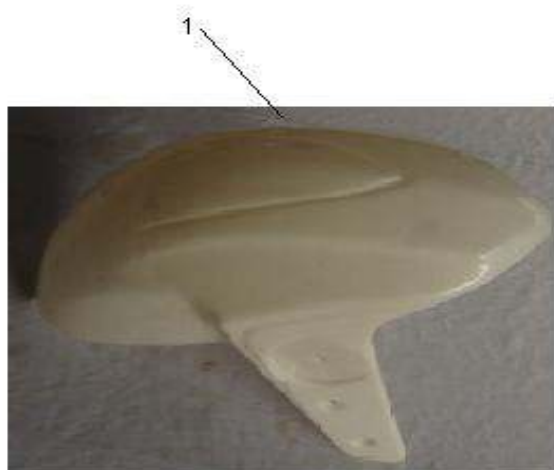

NO.	PART NO.	DESCRIPTION IN SERBIAN	DESCRIPTION IN ENGLISH
1	HL50QT-21(10)-04-001	Prednji blatobran	FENDER .FR
2	HL50QT-21(10)-04-002	Kaadiopter	REFLECTOR,SIDE
3	HL50QT-21(10)-04-003	vijak M6×12	BOLT M 6×12
4	HL50QT-21(10)-04-004	Matica M6	NUT M6

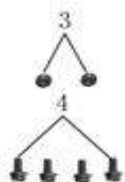
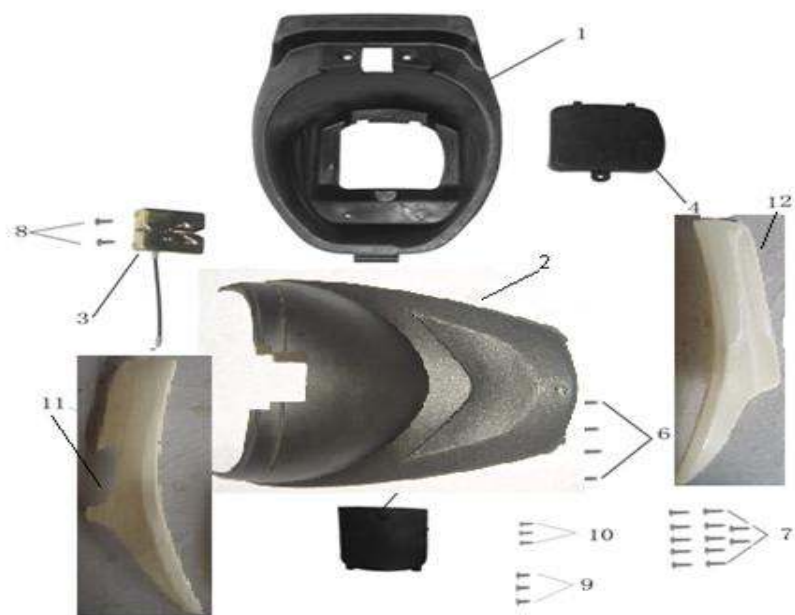
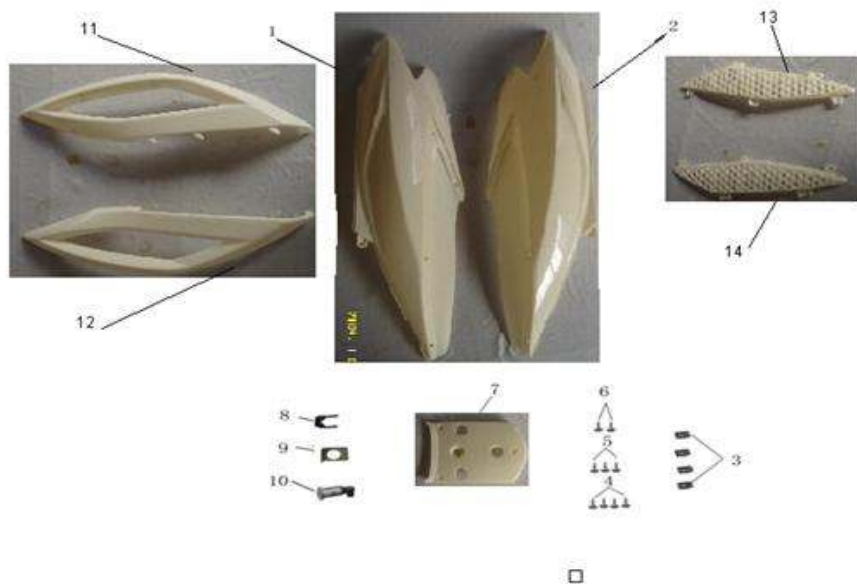

FIG. 05 STORAGE BOX / KUTIJA SEDIŠTA



NO.	PART NO.	DESCRIPTION IN SERBIAN	DESCRIPTION IN ENGLISH
1	HL50QT-21(10)-05-001	Kutija sedišta	STORAGE BOX
2	HL50QT-21(10)-05-002	Nosač tablice	PROTECTING COVER,MIDDLE
3	HL50QT-21(10)-05-003	Bravica	LOCK BRACKET
4	HL50QT-21(10)-05-004	Poklopac kutije sedišta	SMALL COVER
5	HL50QT-21(10)-05-005	Srednji poklopac	COVER MIDDLE
6	HL50QT-21(10)-05-006	vijak M6×15	BOLT M6X15
7	HL50QT-21(10)-05-007	vijak ST4.8X16	SCREW ST4.8X16
8	HL50QT-21(10)-05-008	vijak M6X10	BOLT M6X10
9	HL50QT-21(10)-05-009	vijak ST4.8×12	SCREW ST4.8X12
10	HL50QT-21(10)-05-0010	vijakST4.2×12	SCREW ST4.2X12
11	HL50QT-21(10)-05-0011	Trepna leva	DECK BOARD A
12	HL50QT-21(10)-05-0012	Trepna desna	DECK BOARD B

FIG. 06 SIDE PROTECTING COVER / BOČNE PLASTIKE



NO.	PART NO.	DESCRIPTION IN SERBIAN	DESCRIPTION IN ENGLISH
1	HL50QT-21(10)-06-001	Bočna plastika leva	L. COVER
2	HL50QT-21(10)-06-002	Bočna plastika desna	R. COVER
3	HL50QT-21(10)-06-003	Pipa	CLIP
4	HL50QT-21(10)-06-004	ST4.2×12	SCREW ST 4.2×12
5	HL50QT-21(10)-06-005	ST4.8×16	SCREW ST 4.8×16
6	HL50QT-21(10)-06-006	ST4.2×16	SCREW ST 4.2×16
7	HL50QT-21(10)-06-007	Vezna plastika	CONNECT BOARD
8	HL50QT-21(10)-06-008	Pipa	CLIP
9	HL50QT-21(10)-06-009	Držač bravice	LOCK FIXATION BRACKET
10	HL50QT-21(10)-06-0010	Bravica	LOCK

FIG. 07 STAND FOOTREST / PODNICA

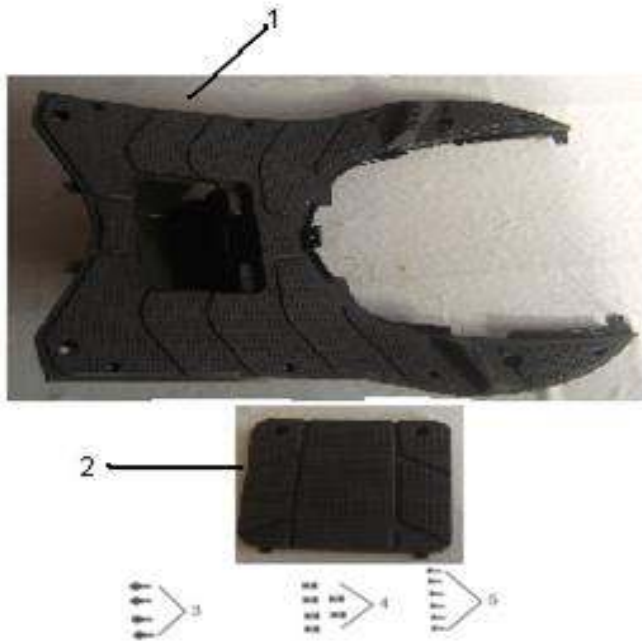

NO.	PART NO.	DESCRIPTION IN SERBIAN	DESCRIPTION IN ENGLISH
1	HL50QT-21(10)-07-001	Podnica	FOOTREST
2	HL50QT-21(10)-07-002	Poklopac akumulatora	COVER BATTERY
3	HL50QT-21(10)-07-003	vijak M6×20	BOLT M 6×20
4	HL50QT-21(10)-07-004	Pipa	CLIP
5	HL50QT-21(10)-07-005	vijak ST4.2×16	SCREW ST4.2×16

FIG. 08 SEAT / SEDIŠTE

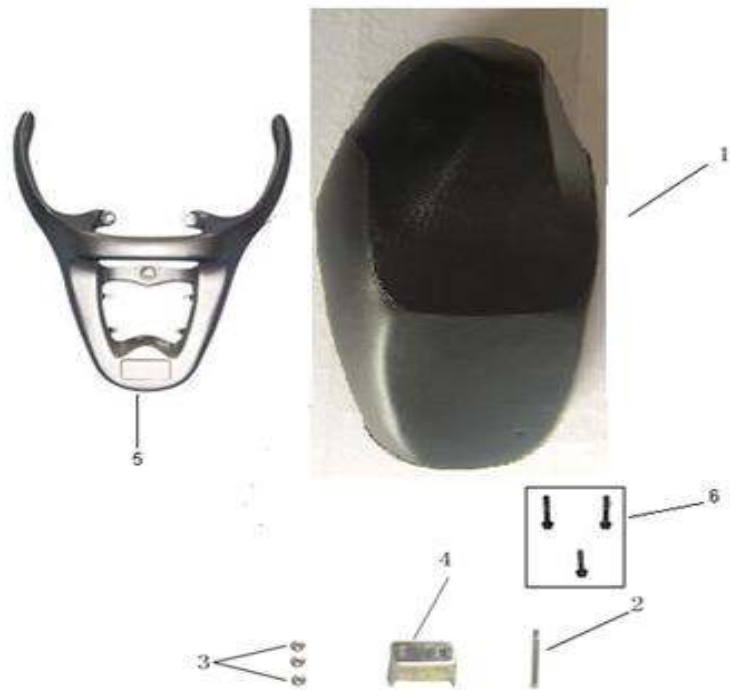

NO.	PART NO.	DESCRIPTION IN SERBIAN	DESCRIPTION IN ENGLISH
1	HL50QT-21(10)-08-001	Sedište	SEAT
2	HL50QT-21(10)-08-002	Vijak M6×65	BOLT M6×65
3	HL50QT-21(10)-08-003	Matica M6	NUT M6
4	HL50QT-21(10)-08-004	Odstojnik	FIXING SHELF
5	HL50QT-21(10)-08-005	Nosac kofera	
6	HL50QT-21(10)-08-006	Vijak	BOLT M8×40

FIG. 9 REAR FENDER / ZADNJI BLATOBTRAN

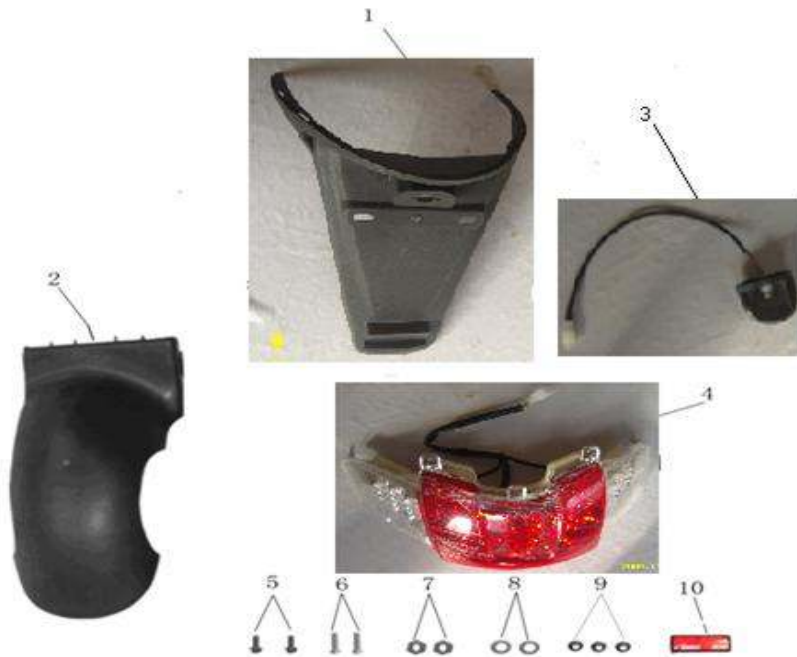

NO.	PART NO.	DESCRIPTION IN SERBIAN	DESCRIPTION IN ENGLISH
1	HL50QT-21(10)-09-001	Nosač tablice	REAR FENDER
2	HL50QT-21(10)-09-002	Zadnji blatobran	REAR WHEEL FENDER
3	HL50QT-21(10)-09-003	Svetlo tablice	license plate LIGHT
4	HL50QT-21(10)-09-004	Štop svetlo	RR TAILLIGHT
5	HL50QT-21(10)-09-005	vijak M6×15	BOLT M 6×15
6	HL50QT-21(10)-09-006	vijak M6×25	BOLT M 6×25
7	HL50QT-21(10)-09-007	matica M10	NUT M10
8	HL50QT-21(10)-09-008	platna	WASHER
9	HL50QT-21(10)-09-009	matica M6	NUT M 6
10	HL50QT-21(10)-09-0010	Katadiopter	REAR REFLECTOR

FIG. 10 FUEL TANK / REZERVOAR



NO.	PART NO.	DESCRIPTION IN SERBIAN	DESCRIPTION IN ENGLISH
1	HL50QT-21(10)-010-001	Rezervoar	FUEL TANK
2	HL50QT-21(10)-010-002	Nosač	BRACKET RR HANDR
3	HL50QT-21(10)-010-003	Čep rezervoara	CAP,FUEL TANK
4	HL50QT-21(10)-010-004	Senzor goriva	SENSOR, FUEL LEVEL
5	HL50QT-21(10)-010-005	Dihtung	RUBBER CUSHION
6	HL50QT-21(10)-010-006	Drzac senzora	FIXING PLATE ,SENSOR
7	HL50QT-21(10)-010-007	Razdelnik	T-BRANCH PIPE
8	HL50QT-21(10)-010-008	Crevo	FUEL PIPE
9	HL50QT-21(10)-010-009	Crevo	NEGATIVE PRESSURE PIPE
10	HL50QT-21(10)-010-0010	Vakuum pumpa	SWITCH, FUEL
11	HL50QT-21(10)-010-0011	Filter	FILTER
12	HL50QT-21(10)-010-0012	vijak M6×16	BOLT M 6×16
13	HL50QT-21(10)-010-0013	Pipa A	CLIP A
14	HL50QT-21(10)-010-0014	Pipa B	CLIP B

FIG. 11 STEERING STEM & FR. ABSORBER / TROUGAO VOLANA I PREDNJI AMORTIZER



NO.	PART NO.	DESCRIPTION IN SERBIAN	DESCRIPTION IN ENGLISH		
1	HL50QT-21(10)-011-001	Trougao volana	STEERING STEM		
2	HL50QT-21(10)-011-002	Prednji levi amortizer	L..FR.ABSORBER		
3	HL50QT-21(10)-011-003	Prednji desni amortizer	R.FR.ABSORBER		
4	HL50QT-21(10)-011-004	Lezajevi volana			
5	HL50QT-21(10)-011-005				
6	HL50QT-21(10)-011-006				
7	HL50QT-21(10)-011-007				
8	HL50QT-21(10)-011-008				
9	HL50QT-21(10)-011-009				
10	HL50QT-21(10)-011-0010				
11	HL50QT-21(10)-011-0011				
12	HL50QT-21(10)-011-0012			vijak M10×35	BOLT M10×35
13	HL50QT-21(10)-011-0013			vijak M6×15	BOLT M 6×15
14	HL50QT-21(10)-011-0014			Nosač blatobrana desni	BRACKET □ FR.FENDER
15	HL50QT-21(10)-011-0015	Držac sajle	PINCHCOCK		
16	HL50QT-21(10)-011-0016	Nosač blatobrana levi	BREACKET □ FR.FENDER		

FIG. 12 FRONT WHEEL / PREDNJI TOČAK



NO.	PART NO.	DESCRIPTION IN SERBIAN	DESCRIPTION IN ENGLISH
1	HL50QT-21(10)-012-001	Guma120/70-12	FR. TYRE
2	HL50QT-21(10)-012-002	Felna 12"	FR. RIM
3	HL50QT-21(10)-012-003	Prednja osovina	SHAFT FR. WHEEL M12×1.5×225
4	HL50QT-21(10)-012-004	Pinjon	ARITHMOMETER
5	HL50QT-21(10)-012-005	matica M12×1.5	NUT M12×1.5
6	HL50QT-21(10)-012-006	Ventil	AIR VALVE
7	HL50QT-21(10)-012-007	Kapica	COVER

FIG. 13 REAR ABSORBER / ZADNJI AMORTIZER



NO.	PART NO.	DESCRIPTION IN SERBIAN	DESCRIPTION IN ENGLISH
1	HL50QT-21(10)-013-001	Zadnji amortizer	RE. ABSORBER
2	HL50QT-21(10)-013-002		
3	HL50QT-21(10)-013-003		
4	HL50QT-21(10)-013-004		
5	HL50QT-21(10)-013-005		
6	HL50QT-21(10)-013-006		

FIG. 14 REAR WHEEL / ZADNJI TOČAK



NO.	PART NO.	DESCRIPTION IN SERBIAN	DESCRIPTION IN ENGLISH
1	HL50QT-21(10)-014-001	Zadnja felna 12"	
2	HL50QT-21(10)-014-002	Guma 120/70-12	
3	HL50QT-21(10)-014-003	Ventil	AIR VALVE
4	HL50QT-21(10)-014-004	Kapica	COVER

FIG. 15 REAR MIRROR / RETROVIZOR



NO.	PART NO.	DESCRIPTION IN SERBIAN	DESCRIPTION IN ENGLISH
1	HL50QT-21(10)-015-001	Levi retrovizor	L.REAR MIRROR
2	HL50QT-21(10)-015-002	Desni retrovizor	R.REAR MIRROR

FIG. 16 AIR FILTER / FILTER VAZDUHA

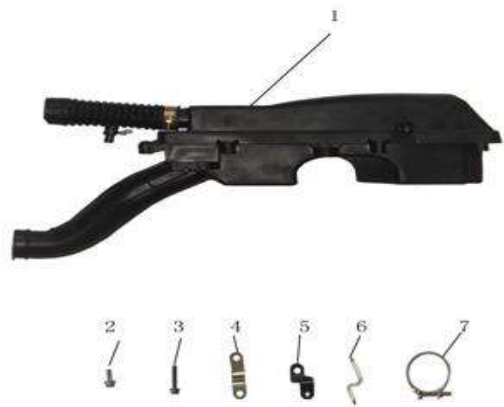

NO.	PART NO.	DESCRIPTION IN SERBIAN	DESCRIPTION IN ENGLISH
1	HL50QT-21(10)-016-001	Kućište filtera	BODY, FILTER
2	HL50QT-21(10)-016-002	vijak M6×20	BOLT M6×20
3	HL50QT-21(10)-016-003	vijak M6×40	BOLT M6×40
4	HL50QT-21(10)-016-004		
5	HL50QT-21(10)-016-005		
6	HL50QT-21(10)-016-006		
7	HL50QT-21(10)-016-007	Pipa	CLIP

FIG. 17 FR. DISK BRAKE & REAR BRAKE / PREDNJA I ZADNJA KOČNICA



NO.	PART NO.	DESCRIPTION IN SERBIAN	DESCRIPTION IN ENGLISH
1	HL50QT-21(10)-017-001	Prednji kočioni sistem	FR. DISK BRAKE
2	HL50QT-21(10)-017-002	Sajla zadnje kočnice	REAR BRAKE CABLE
3	HL50QT-21(10)-017-003	Kočioni disk	BRAKE DISK
4	HL50QT-21(10)-017-004	vijak M8×36	BOLT8×36
5	HL50QT-21(10)-017-005	Opruga A	SPRING A
6	HL50QT-21(10)-017-006	Opruga B	SPRING B
7	HL50QT-21(10)-017-007		
8	HL50QT-21(10)-017-008		
9	HL50QT-21(10)-017-009		
10	HL50QT-21(10)-017-0010	matrica M6	NUT
11	HL50QT-21(10)-017-0011	Pakne	BRAKE SHOE

FIG. 18 MUFFLER / AUSPUH



NO.	PART NO.	DESCRIPTION IN SERBIAN	DESCRIPTION IN ENGLISH
1	HL50QT-21(10)-018-001	Auspuh	TUBE, ALUMINUM MUFFLER
2	HL50QT-21(10)-018-002	Dihitung na cilindru	SEAL
3	HL50QT-21(10)-018-003	Dihitung	
4	HL50QT-21(10)-018-004	Izdovna grana	EXHAUST PIPE
5	HL50QT-21(10)-018-005		
6	HL50QT-21(10)-018-006		
7	HL50QT-21(10)-018-007		
8	HL50QT-21(10)-018-008		
9	HL50QT-21(10)-018-009		
10	HL50QT-21(10)-018-0010		

FIG. 19 STAND / NOGARE



NO.	PART NO.	DESCRIPTION IN SERBIAN	DESCRIPTION IN ENGLISH
1	HL50QT-21(10)-019-001	Centralna nogara	MAIN STAND
2	HL50QT-21(10)-019-002	Bočna nožica	SIDE STAND
3	HL50QT-21(10)-019-003	Opruga bočne nogare	SPRING SIDE STAND
4	HL50QT-21(10)-019-004	vijak M8×25	BOLT M8×25
5	HL50QT-21(10)-019-005	Opruga centralne nogare	SPRING MAIN STAND
6	HL50QT-21(10)-019-006	Pin	PIN

FIG. 20 FRAME / RAM



NO.	PART NO.	DESCRIPTION IN SERBIAN	DESCRIPTION IN ENGLISH
1	HL50QT-21(10)-020-001	Ram	FRAME

FIG. 21 CABLE / SAJLE

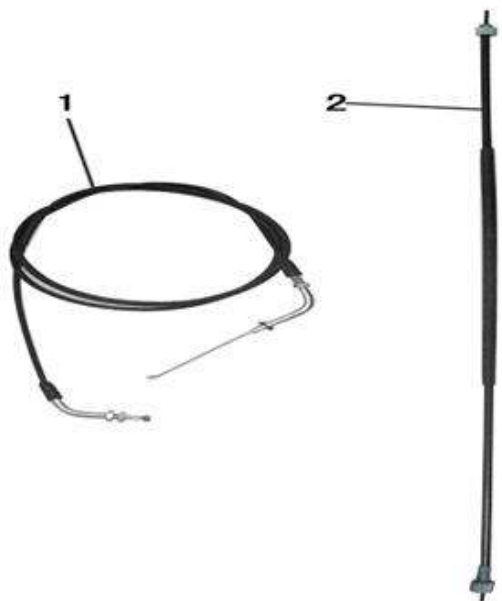

NO.	PART NO.	DESCRIPTION IN SERBIAN	DESCRIPTION IN ENGLISH
1	HL50QT-21(10)-021-001	Sajla gasa	ACCELEROGRAPH CABLE
2	HL50QT-21(10)-021-002	KM sajla	FLEXIBLE SHAFT, SPEEDMETER

FIG. 22 FRONT PROTECTING BOARD / PREDNJA PODNICA

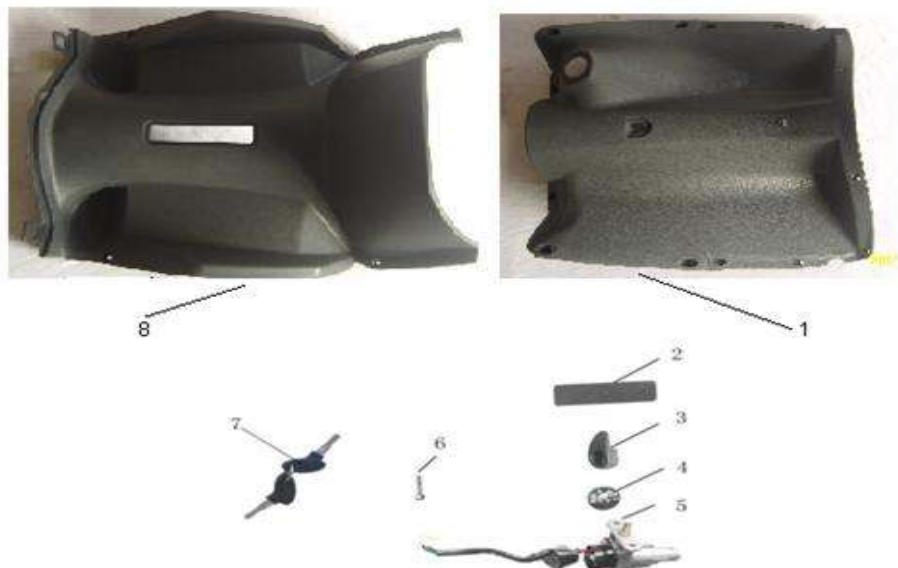

NO.	PART NO.	DESCRIPTION IN SERBIAN	DESCRIPTION IN ENGLISH
1	HL50QT-21(10)-022-001	Prednja podnica gornja	
2	HL50QT-21(10)-022-002	Poklopac br. Šasije	COVER VIN NO
3	HL50QT-21(10)-022-003	Kuka	HOOK
4	HL50QT-21(10)-022-004		COVER
5	HL50QT-21(10)-022-005	Kontakt bravica	IGNITING SWITCH
6	HL50QT-21(10)-022-006	vijakM6×30	BOLT M6×30
7	HL50QT-21(10)-022-007	Ključ	KEY
8	HL50QT-21(10)-022-008	Prednja podnica donja	

FIG. 23 FENDER AT BOTTOM / UNUTRAŠNJI BLATOBAN



NO.	PART NO.	DESCRIPTION IN SERBIAN	DESCRIPTION IN ENGLISH
1	HL50QT-21(10)-023-001	Unutrašnji blatobran	FENDER AT BOTTOM
2	HL50QT-21(10)-023-002		
3	HL50QT-21(10)-023-003	vijak	SCREW ST 4.8X16
4	HL50QT-21(10)-023-004		

FIG. 24 ELECTRICAL / INSTALACIJA



NO.	PART NO.	DESCRIPTION IN SERBIAN	DESCRIPTION IN ENGLISH
1	HL50QT-21(10)-024-001	Instalacije	WIRING HARNESS
2	HL50QT-21(10)-024-002	Osigurač	FUSE
3	HL50QT-21(10)-024-003		
4	HL50QT-21(10)-024-004	Kabl minusa	NEGATIVE WIRE, COMP.
5	HL50QT-21(10)-024-005	vijak	BOLT M6×12
6	HL50QT-21(10)-024-006	vijak	BOLT M6×16
7	HL50QT-21(10)-024-007	Regler	RECTIFIER
8	HL50QT-21(10)-024-008	Automat žmigavca	FLASHER
9	HL50QT-21(10)-024-009	Rele paljenja	RELAY
10	HL50QT-21(10)-024-0010	Kabl plusa	"+" CABLE
11	HL50QT-21(10)-024-0011	Sirena	HORN
12	HL50QT-21(10)-024-0012	CDI	C.D.I
13	HL50QT-21(10)-024-0013	vijak	BOLT M6×12
14	HL50QT-21(10)-024-0014	Bobina	COIL ASSY, IGNITION
15	HL50QT-21(10)-024-0015	vijak	BOLT M5×25

FIG. 25 BATTERY / AKOMULATOR

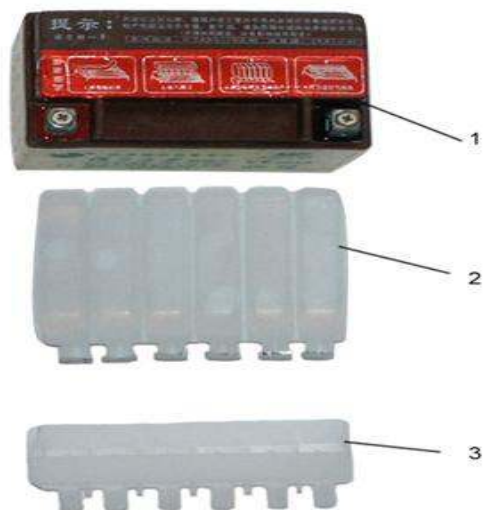

NO.	PART NO.	DESCRIPTION IN SERBIAN	DESCRIPTION IN ENGLISH
1	HL50QT-21(10)-025-001	AKOMULATOR	BATTERY
			BATTERY
			BATTERY
2	HL50QT-21(10)-025-002	Kiselina	ELECTROLYTE
3	HL50QT-21(10)-025-003	Levak	TUNDISH

FIG. 26 TOOL / ALAT



NO.	PART NO.	DESCRIPTION IN SERBIAN	DESCRIPTION IN ENGLISH
1	HL50QT-21(10)-026-001	Ključ	SPANNER14-17
2	HL50QT-21(10)-026-002	Ključ	SPANNER8-10
3	HL50QT-21(10)-026-003	Ključ	SPANNER10-12
4	HL50QT-21(10)-026-004	Imbus	INNER HEXAGON SPANNER
5	HL50QT-21(10)-026-005	Ključ za svećice	SLEEVE
6	HL50QT-21(10)-026-006	Odvrtáč	SCREWDRIVER,DOUBLE-ENDED
7	HL50QT-21(10)-026-007	Drška	HANDLE,SCREWDRIVER
8	HL50QT-21(10)-026-008	Kesica	BAG,TOOL